

## CH, CHN 50 Hz

### CH, CHN 2

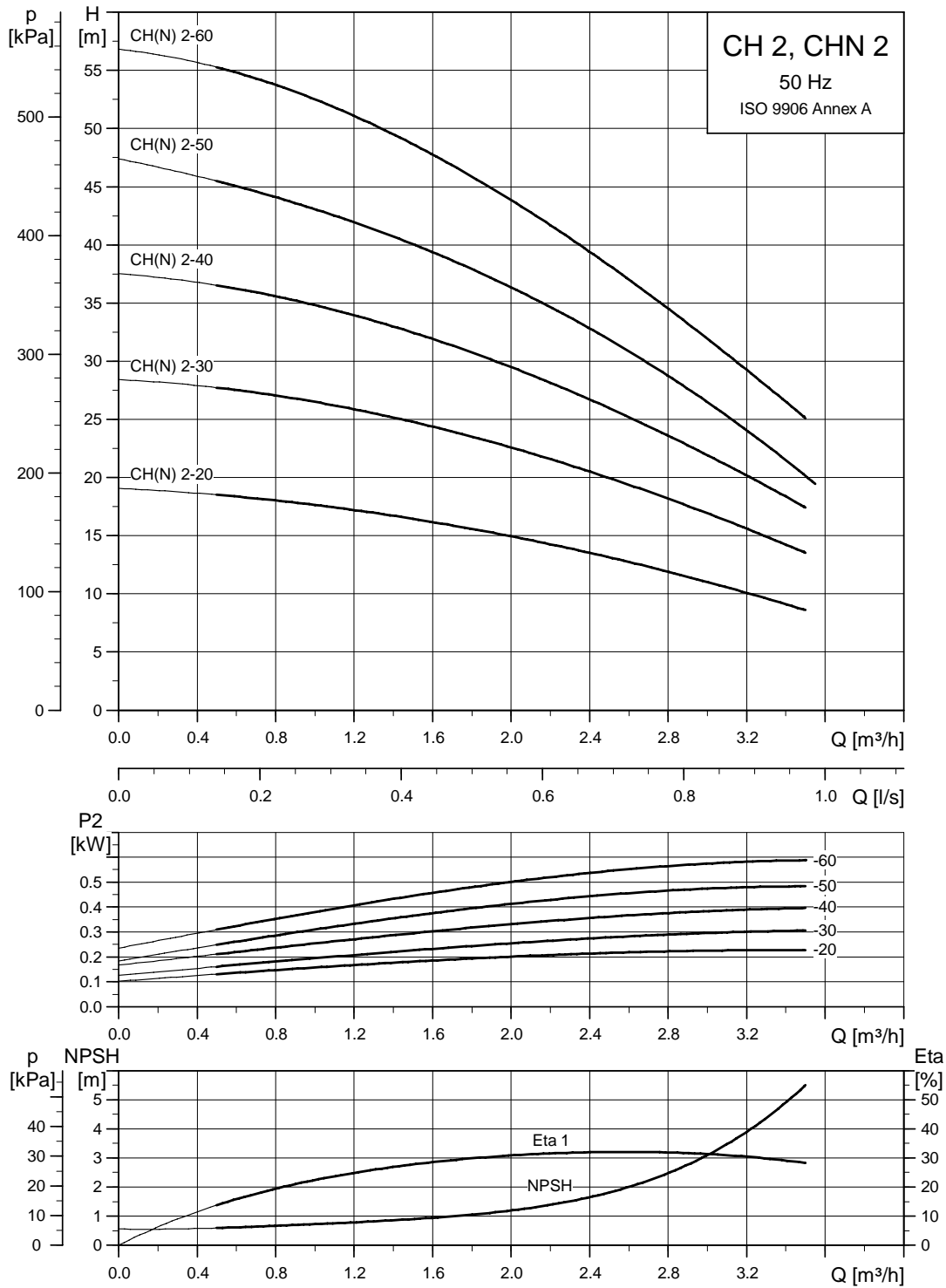

TM03 8456 1607

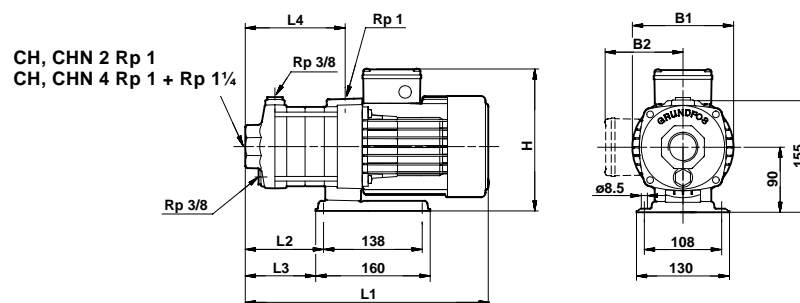

Fig. 5 Dimensional sketches, CH, CHN 2 and 4 with MG 71/80 motor

TM00 1491 4900

## Dimensions

Voltage [V]	Frequency [Hz]	Pump type	Motor type	L1 [mm]	L2 [mm]	L3 [mm]	L4 [mm]	B1 [mm]	B2 [mm]	H [mm]
1 x 220-240	50	CH, CHN 2-20	MG 71	304	74	63	99	146	115	205
		CH, CHN 2-30	MG 71	322	92	81	117	146	115	205
		CH, CHN 2-40	MG 71	340	110	99	135	146	115	205
		CH, CHN 2-50	MG 71	358	128	117	154	146	115	205
		CH, CHN 2-60	MG 71	376	146	135	172	146	115	205
3 x 220-240/380-415	50	CH, CHN 2-20	MG 71	304	74	63	99	146	110	200
		CH, CHN 2-30	MG 71	322	92	81	117	146	110	200
		CH, CHN 2-40	MG 71	340	110	99	135	146	110	200
		CH, CHN 2-50	MG 71	358	128	117	154	146	110	200
		CH, CHN 2-60	MG 71	376	146	135	172	146	110	200
3 x 200-220/346-380 3 x 200-230/346-400	50	CH, CHN 2-20	MG 71	304	74	63	99	141.5	110	200
	60	CH, CHN 2-30	MG 71	322	92	81	117	141.5	110	200
		CH, CHN 2-40	MG 80	380	110	99	135	141.5	110	200
		CH, CHN 2-50	MG 80	398	128	117	154	141.5	110	200
		CH, CHN 2-60	MG 80	416	146	135	172	141.5	110	200

## Weights

Pump type	Single-phase			Three-phase		
	Net weight [kg]	Gross weight [kg]	Shipping volume [m <sup>3</sup> ]	Net weight [kg]	Gross weight [kg]	Shipping volume [m <sup>3</sup> ]
CH, CHN 2-20	9.6	11.4	0.0187	11.1	11.8	0.0187
CH, CHN 2-30	9.6	11.4	0.0187	10.7	11.6	0.0187
CH, CHN 2-40	10.9	11.5	0.0187	11.0	11.7	0.0187
CH, CHN 2-50	11.3	12.0	0.0235	11.5	12.2	0.0235
CH, CHN 2-60	11.6	12.3	0.0235	11.8	12.5	0.0235

## Electrical data

Voltage [V]	Frequency [Hz]	Pump type	Motor type	I <sub>1/1</sub> [A]	I <sub>st</sub> [A]	P <sub>1</sub> [W]	P <sub>2</sub> [W]	C [μF/V]
1 x 220-240	50	CH, CHN 2-20	MG 71	2.2	10.5	420	205	10/400
		CH, CHN 2-30	MG 71	2.3	10.5	480	280	10/400
		CH, CHN 2-40	MG 71	2.6	10.5	570	370	10/400
		CH, CHN 2-50	MG 71	2.9	10.5	680	450	10/400
		CH, CHN 2-60	MG 71	3.7	13	800	560	16/400
3 x 220-240/380-415	50	CH, CHN 2-20	MG 71	1.6/0.9	11.4/6.6	380	230	
		CH, CHN 2-30	MG 71	1.7/1	11.4/6.6	460	300	
		CH, CHN 2-40	MG 71	1.9/1.1	11.4/6.6	570	400	
		CH, CHN 2-50	MG 71	2.35/1.25	11.4/6.6	800	560	
		CH, CHN 2-60	MG 71	2.55/1.35	11.4/6.6	820	580	
3 x 200-220/346-380**	50	CH, CHN 2-20	MG 71	2.5/1.6	16.2/14.3	370	230	
		CH, CHN 2-30	MG 71	2.5/1.6	16.2/14.3	450	300	
		CH, CHN 2-40	MG 80	3.3/2.1	21.6/18.8	590	400	
		CH, CHN 2-50	MG 80	3.4/2.1	21.6/18.8	690	490	
		CH, CHN 2-60	MG 80	4.0/2.3	30.8/30.8	790	600	

\*\* Dual-frequency pump; can be used for both 50 and 60 Hz in the voltage range stated.